

# Catalog Number: MK0603S1400SDS

## Features and Ratings

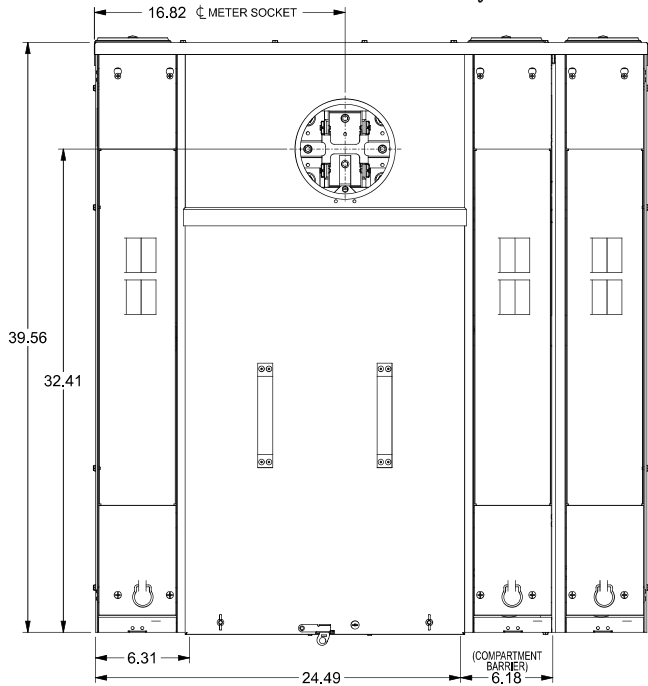

- Outdoor Enclosure (Type 3R)
- 400A Max, 1 Phase, 3 Wire, 120/240V~
- 22,000 AIC Max. Rated (See Wiring Diagram for Details)
- Meter Socket Rating: 320A Continuous, 400A Max.
- Ring Type Meter Cover
- Manual Bypass
- Underground Service Only, Surface Mounting
- (2) Service Disconnects in Separate Compartments
- Uses HD Type Hubs
- For Photovoltaic or Alternate Energy applications (200A Max.)
- Complies with EUSERC Dwg. No. 302A

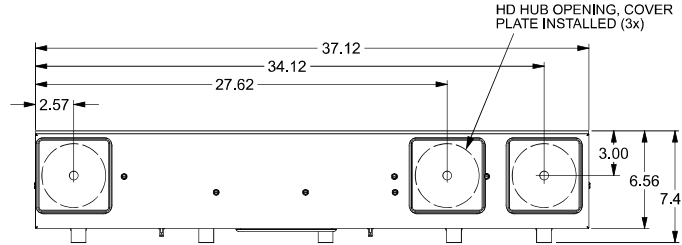
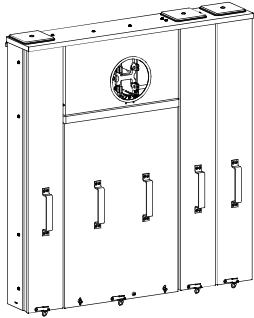

View Shown Without Compartment Covers

View Shown Without Covers and Deadfronts

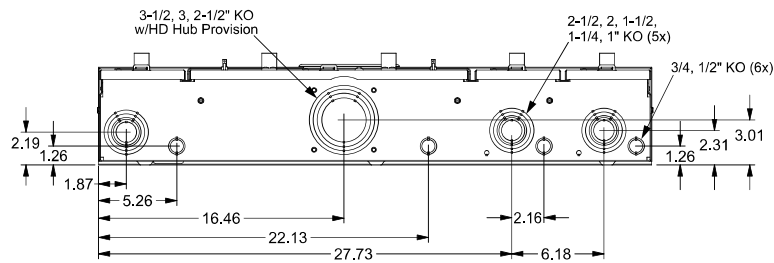
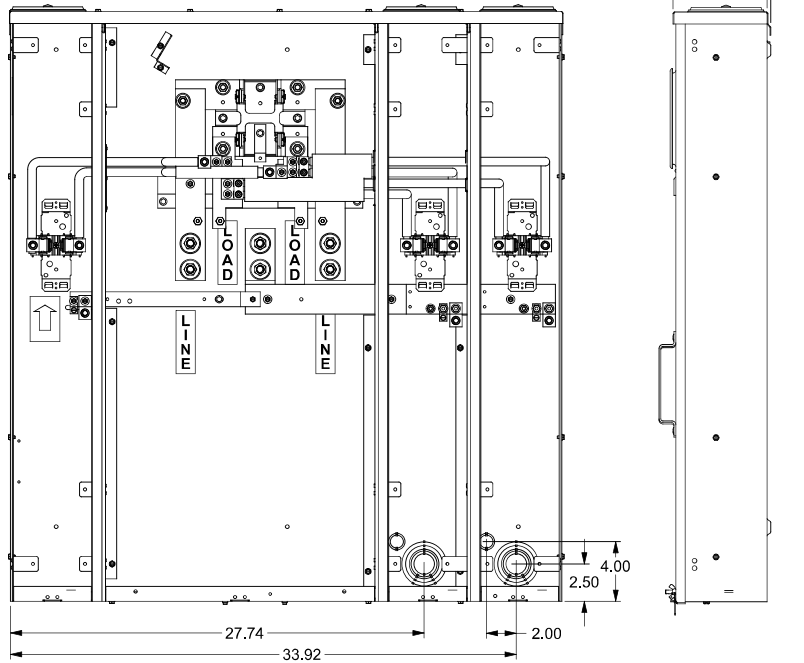

### Compartment Deadfront View

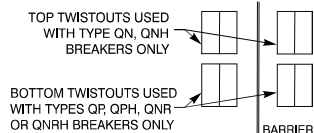

## Accessories

If hub is required, use Type HD catalog numbers listed below:  
**Trade size (in) Catalog No.**  
 2" EC56854  
 2 1/2" EC56855  
 3" EC56856  
 3 1/2" EC56857  
 4" EC56858  
 Closure Plate EC56933S

Filler Plate .....OF3 or ECOF3  
 200A Main Breaker .....QN2200H / QN2200RH  
 150A Main Breaker .....QN2150H / QN2150RH  
 Lug #6-350 kcmil .....SUK350TA  
 Lug #2-600 kcmil .....SUK600TA  
 Lug 500-1000 kcmil .....SUK1000TA  
 Flush Rail Kit .....ECFRK2  
 Ground Bar (5 pos) .....ECGB5  
 Lug, 2/0 AWG (G2) .....ECLK2N  
 Lug, 300kcmil (G2) .....ECLK3N  
 LTB KIT for QNR .....ECLTB3  
 Main Brkr Holddown Kit .....ECL387HD

## Torques & Wire Sizes

### Load, Neutral and Ground Terminals

Terminal	Wire Size	Torque
A, B, N		
SUK350TA	(2)#6-350 kcmil	275 lb-in
SUK600TA	#2-600 kcmil	375 lb-in
SUK1000TA	500-1000 kcmil	500 lb-in
N1	300 kcmil - #4	250 lb-in
G1	#2 - #14	50 lb-in
G2	ECLK2N	110 lb-in
	ECLK3N	250 lb-in
Branch Breaker Terminals	See Markings on Breaker	

### Equipment Ground Bar

Terminal Size	Wire Size	Torque
(1, 2 or 3)	#14 CU	20 lb-in
(1 or 2)	#10-12 AL/CU	20 lb-in
#4-#14 (ECGB5)	#8 AL/CU	25 lb-in
	#6 - 4 AL/CU	35 lb-in

**Line Terminals:** Provisions for UL listed NEMA mounting terminals. Compression terminals to #750 kcmil, single conductor, ILSCO type 2ACL. See lug manufacturer's instruction sheet supplied with the connector for tool, die, and number of crimps.

**Tightening Torques:** 5/16" Nuts(1/2" Drive)...130-140 in-lbs  
 3/8" Nuts(3/16" Drive)...240-260 in-lbs  
 1/2" Nuts(3/4" Drive) ....490-540 in-lbs

## Schematic

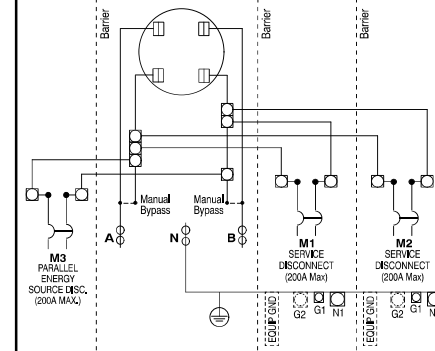

© 2021 Copyright Siemens Industry, Inc.

**SIEMENS**  
Siemens Industry, inc.

## SolarReady™ Meter Combination

Description: 400A Max, Outdoor, Ring Type, UG Service, Manual Bypass, 2-SD Compartments, Surf. Mount

KAM 4/14/21 Fam - DO NOT SCALE DRAWING Dwg. No. **MK0603S1400SDS**